

CP BOWERS
 N 37° 22' 14.2"
 W 121° 58' 54.5"
 ELEV. WRT MSL: 56 FT.
 M.P. 41.6

CP HENDY
 N 37° 22' 30.8"
 W 122° 1' 11.1"
 ELEV. WRT MSL: 103 FT.
 M.P. 39.4



CP MARY
 N 37° 22' 52.1"
 W 122° 2' 18.5"
 ELEV. WRT MSL: 97 FT.
 M.P. 38.2

CP MAYFIELD
 N 37° 24' 42.9"
 W 122° 6' 51.3"
 ELEV. WRT MSL: 33 FT.
 M.P. 33.8

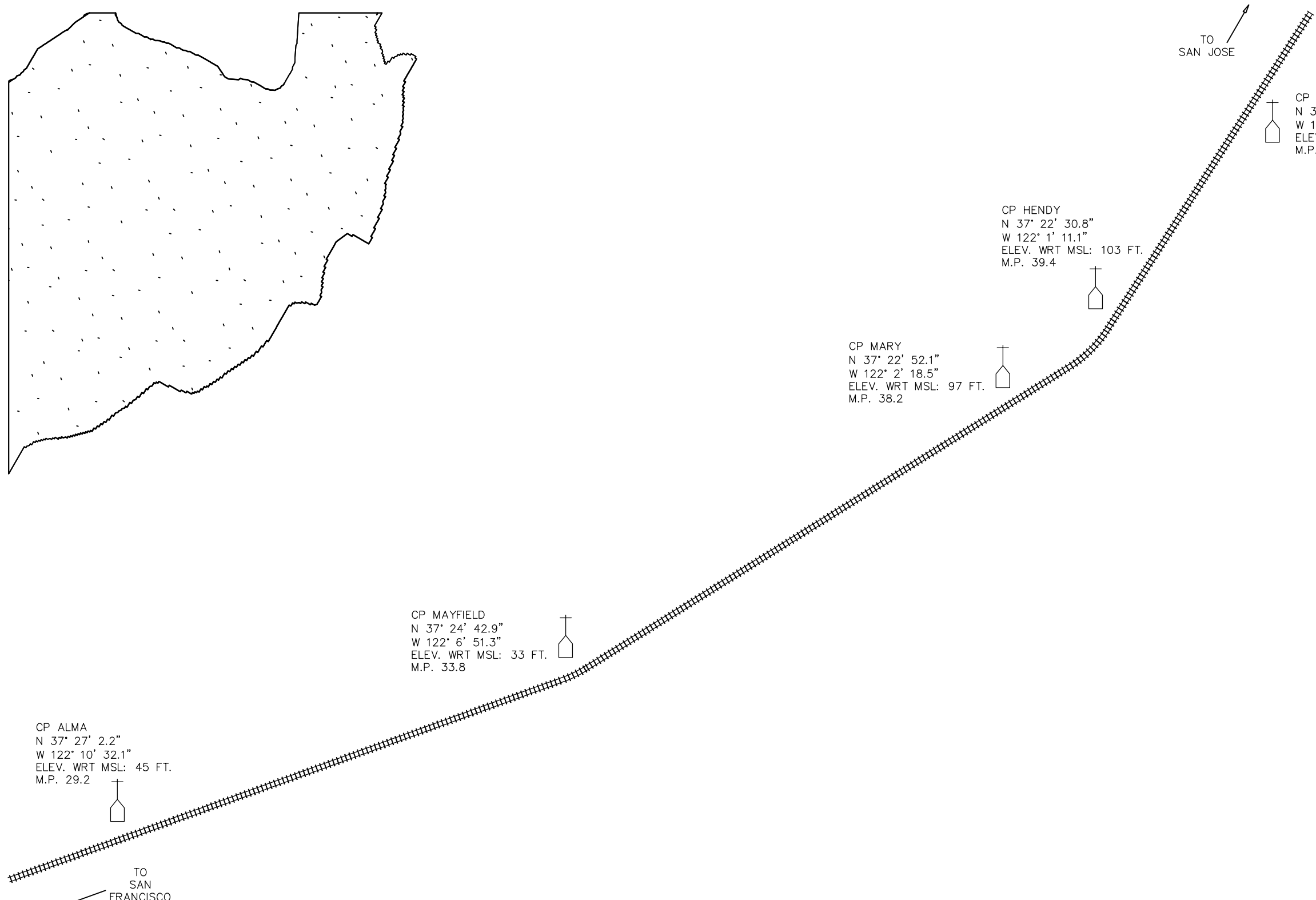
CP ALMA
 N 37° 27' 2.2"
 W 122° 10' 32.1"
 ELEV. WRT MSL: 45 FT.
 M.P. 29.2

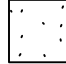

LEGEND:

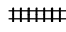
-  WATER
-  BRIDGE
-  RAILROAD TRACKS

REFERENCE ONLY

REV	DATE	BY	CHK	APP	DESCRIPTION

PENINSULA CORRIDOR JOINT POWERS BOARD

APPROVED BY:

 ENGINEERING MANAGER

 DEPUTY DIRECTOR OF ENGINEERING

1250 San Carlos Avenue
San Carlos, CA 94070

STANDARD DRAWINGS		CADD FILE NO.:
TRAIN CONTROL COMMUNICATION ATCS (DATA) RADIO SYSTEM SINGLE LINE DRAWING CP ALMA TO CP BOWERS		SD-6503
REV	DATE	
0	093011	
TRAIN CONTROL		
STANDARD NO.:		SD-6503