

BILL OF MATERIAL				BILL OF MATERIAL			
ITEM	QTY	DESCRIPTION	DWG NO	ITEM	QTY	DESCRIPTION	DWG NO
1	1	HOLLOW SWITCH TIE & RODDING ASSEMBLY	SD-2720	23	2	SWITCH PLATE (20-30LC)	SD-2744
2	1	SAMSON POINT, 67'-0" LONG, DOUBLE REINFORCED, UR MANG TIP, LH	SD-2709	24	2	SWITCH PLATE (20-31LC)	SD-2744
3	1	SAMSON POINT, 67'-0" LONG, DOUBLE REINFORCED, UR MANG TIP, RH	SD-2710	25	2	SWITCH PLATE (20-32LC)	SD-2745
4	1	SAMSON STOCK RAIL, 69'-8" LONG, CURVED, LH	SD-2711	26	2	SWITCH PLATE (20-33LC)	SD-2745
5	1	SAMSON STOCK RAIL, 76'-0" LONG, STRAIGHT, RH	SD-2712	27	2	SWITCH PLATE (20-34LC)	SD-2745
6	1	SWITCH HEEL BLOCK, 136 LB RE, UNIFORM RISER, LH	-	28	2	SWITCH PLATE (20-35LC)	SD-2745
7	1	SWITCH HEEL BLOCK, 136 LB RE, UNIFORM RISER, RH	-	29	2	SWITCH PLATE (20-36LC)	SD-2745
8	2	SWITCH PLATE (BP1C-136)	SD-2301	30	2	SWITCH PLATE (20-37LC)	SD-2745
9	16	SWITCH PLATE (BP2C-136)	SD-2301	31	2	SWITCH PLATE (20-38LC)	SD-2746
10	14	SWITCH PLATE (P4C-136)	SD-2301	32	2	SWITCH PLATE (20-39LC)	SD-2746
11	4	SWITCH ROLLER PLATE (RP-1-136) SCHWIHAG	SD-2311	33	2	SWITCH PLATE (20-40LC)	SD-2746
12	4	SWITCH ROLLER PLATE (RP-2-136) SCHWIHAG	SD-2312	34	2	ROLLER SCHWIHAG, SINGLE	-
13	1	SWITCH PLATE (20-25LLC)	SD-2743	35	4	ROLLER SCHWIHAG, DOUBLE	-
14	1	SWITCH PLATE (20-25LRC)	SD-2743	36	2	ROLLER SCHWIHAG, TRIPLE	-
15	1	SWITCH PLATE (20-26LLC)	SD-2743	37	22	BRACE, BOLTLESS, 136 LB RE 'SUREFIT'	-
16	1	SWITCH PLATE (20-26LRC)	SD-2743	38	22	SERRATED WASHER FOR BOLTLESS BRACE	-
17	1	SWITCH PLATE (20-27LLC)	SD-2743	39	142	CLIP, PANDROL, E2055	-
18	1	SWITCH PLATE (20-27LRC)	SD-2743	40	6	BOLT, 1 1/8" DIA X 10 1/2" LONG, SQUARE HEAD, DRILLED @ 10 1/16", GR 5	-
19	1	SWITCH PLATE (20-28LLC)	SD-2744	41	6	SPRING WASHER FOR 1 1/8" DIA BOLT	-
20	1	SWITCH PLATE (20-28LRC)	SD-2744	42	6	NUT, 1 1/8" DIA HEAVY SQUARE, GR 5	-
21	1	SWITCH PLATE (20-29LLC)	SD-2744	43	6	COTTER PIN, 1/4" DIA X 2 1/4" LONG	-
22	1	SWITCH PLATE (20-29LRC)	SD-2744	44	2	FISH PLATE, 3-HOLE, 1/2" D-BAR X 16" LONG, HEADLOCKED	-
				45	2	FISH PLATE, 3-HOLE, 1/2" D-BAR X 16" LONG	-

**NOTES:**

- SEE DRAWING SD-2716 FOR TIE LOCATION DIMENSIONS
- SWITCH RODS SHALL BE PREADJUSTED TO DIMENSIONS SHOWN IN DETAIL FOR EACH ROD LOCATION. MODIFY SPREADS AS NECESSARY WHEN INSTALLING INTO LAYOUT

**TYPICAL BOLTLESS BRACE ASSEMBLY**

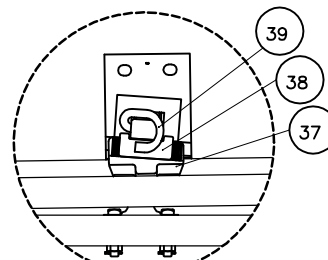

**TYPICAL SWITCH HEEL ASSEMBLY**

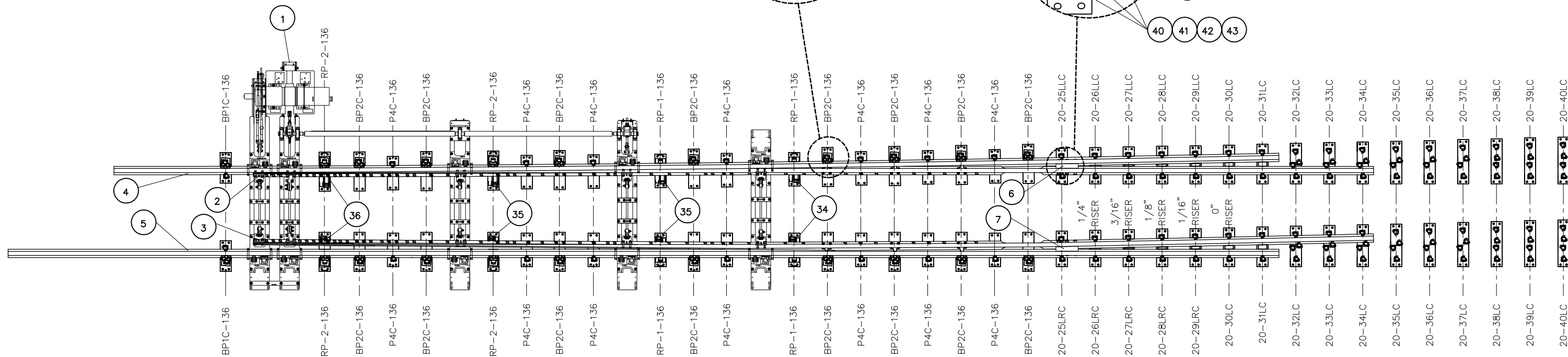
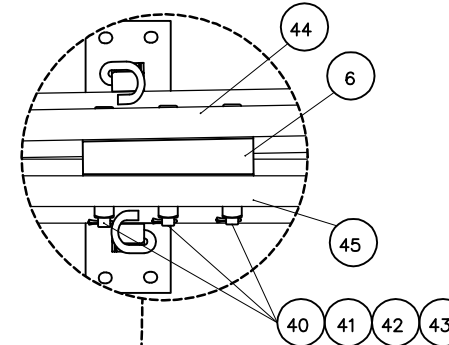

**PENINSULA CORRIDOR JOINT POWERS BOARD**

**STANDARD DRAWINGS**

REV	DATE	BY	CHK	APP	DESCRIPTION

APPROVED BY:  
*Bernard Anagnostis* ENGINEERING MANAGER  
*Steph Chen* DEPUTY DIRECTOR OF ENGINEERING



**SPECIAL TRACKWORK**  
**NO 20 TURNOUT**  
**LH SWITCH PACK WITH HST**  
**SWITCH MACHINE ON TURNOUT SIDE**

CADD FILE NO.: SD-2707	
REV 0	DATE 093011
STANDARD NO.: SD-2707	