

**40' LONG TRANSITION RAIL - 119 RE TO 136 RE**

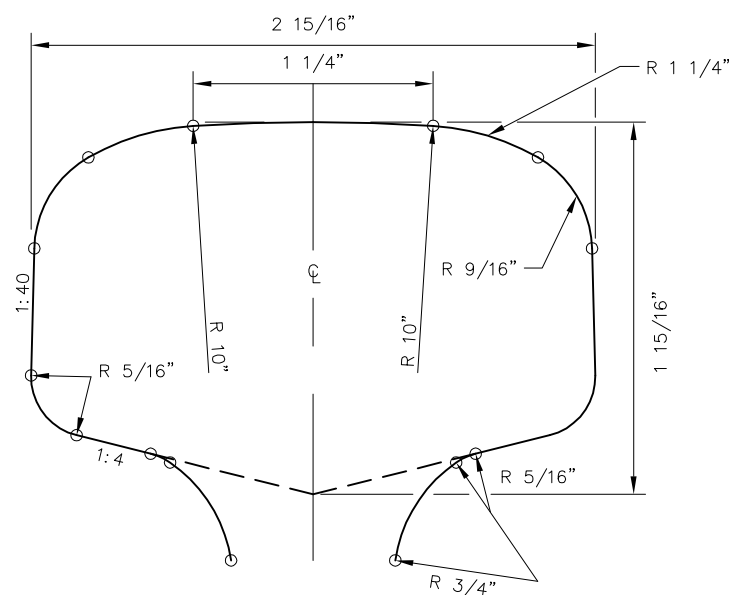

**TOP RADII DETAIL  
136 RE**

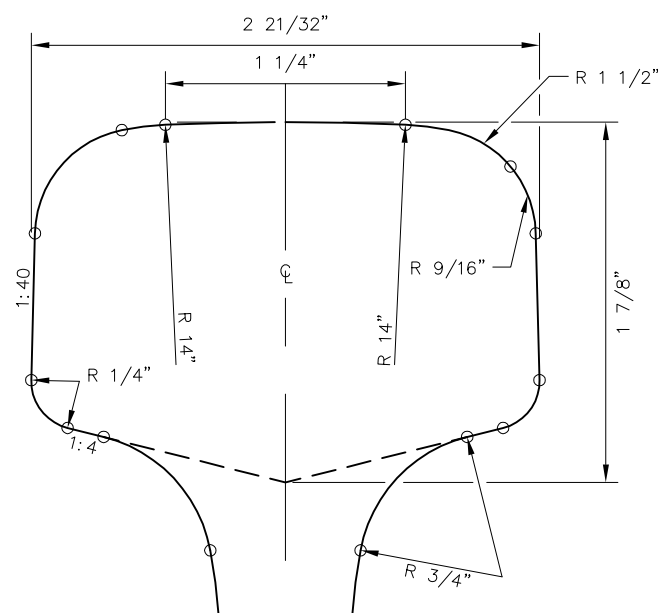

**TOP RADII DETAIL  
119 RE**

**NOTES:**

1. RAIL SHALL BE PURCHASED AND MANUFACTURED TO CURRENT CALTRAIN SPECIFICATIONS AND STANDARD DRAWINGS
2. TRANSITION RAIL SHALL BE MANUFACTURED FROM HEAD HARDENED RAIL
3. MACHINED SURFACES SHALL BE FREE OF SEAMS AND RIDGES
4. TEMPLATES SHALL BE USED TO CHECK FINISHED GAUGE CORNER AND TOP RADII
5. MANUFACTURER SHALL MARK LIFT/BALANCE POINT FOR EACH RAIL LENGTH AND ACTUAL WEIGHT OF RAIL, STENCILED ON HEAD OF RAIL
6. MANUFACTURER SHALL PAINT WEB OF RAIL, 10 FEET AS SHOWN ON RAIL, SOLID WHITE, BOTH SIDES. USING 2 1/2" BLOCK STENCIL AND BLACK PAINT, MARK RAIL TRANSITIONS, I.E. 136 RE AND 132 RE AT EACH END OF THE WHITE PAINTING. STENCIL IN BLACK THE MANUFACTURER NAME AND S/N BETWEEN MARKING RAIL TRANSITIONS USING 2" BLOCK STENCIL
7. TRANSITION RAIL IS UNIVERSAL AND CAN BE USED AS RIGHT HAND OR LET HAND RAIL
8. TRANSITION RAILS SHALL BE USED ONLY ON TANGENT TRACKS

REV	DATE	BY	CHK	APP	DESCRIPTION

**PENINSULA CORRIDOR JOINT POWERS BOARD**

APPROVED BY:

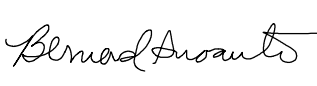
  
 ENGINEERING MANAGER

  
 DEPUTY DIRECTOR OF ENGINEERING

  
1250 San Carlos Avenue  
San Carlos, CA 94070

STANDARD DRAWINGS		CADD FILE NO.:
<b>TRACK RAILS, TIES, AND FASTENERS FORGED TRANSITION RAILS FOR 119 RE TO 136 RE</b>		SD-2232
REV	DATE	
0	093011	
TRACK		
STANDARD NO.:		SD-2232